

CFMN-120CAC/15-AF-G

Old Type Designation: MC1C-120E

www.comet.ch

Specifications	
Capacity C_{max} (nominal)	120 pF
Voltage (Peak Test U_{pt} / Peak Working U_{pw})	15 kV / 9 kV
Capacity Tolerance	5%
Max. Current I_{max} at 13.56 MHz with Conduction Cooling	65 Arms 50 W
Net Weight	0.38 kg

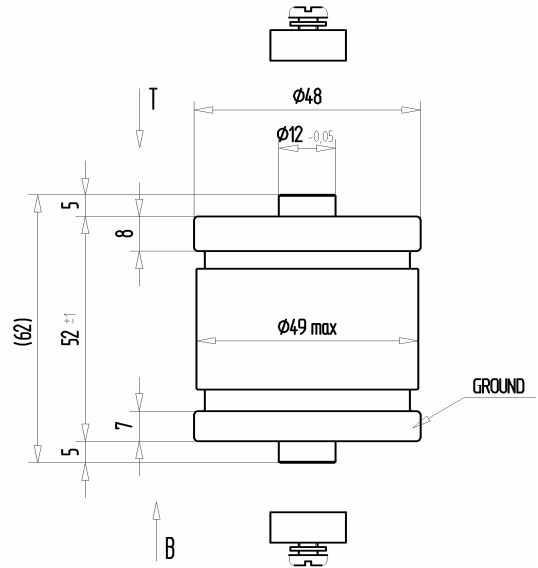

I_{max} at 25°C ambient and 125°C surface temp. for convection and conduction (50 W) cooling

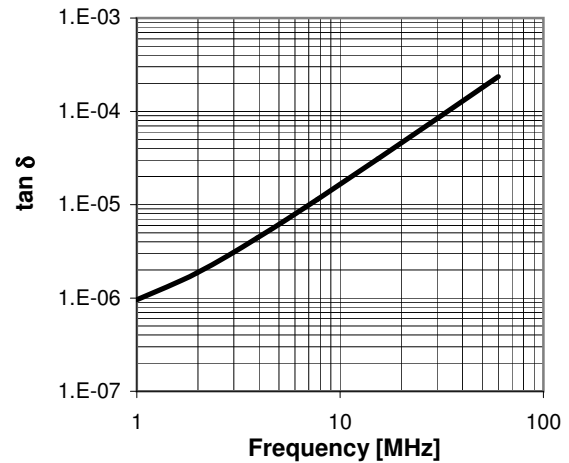
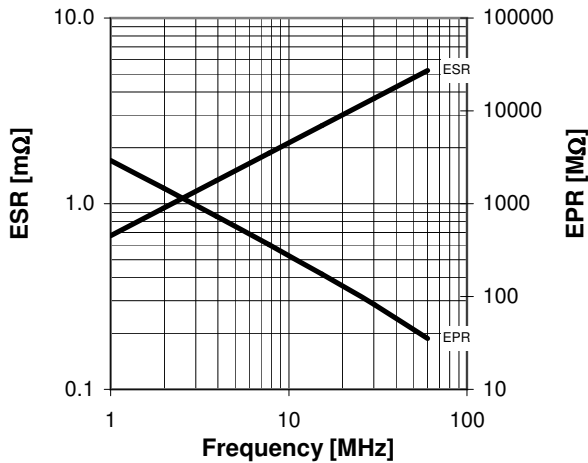
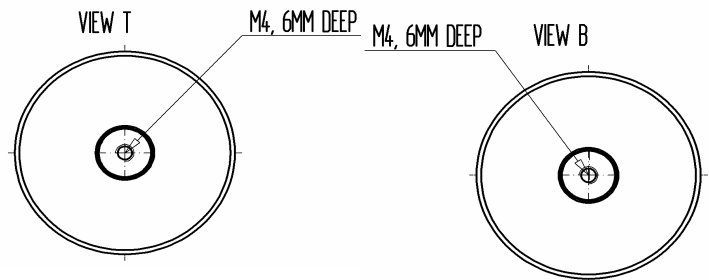
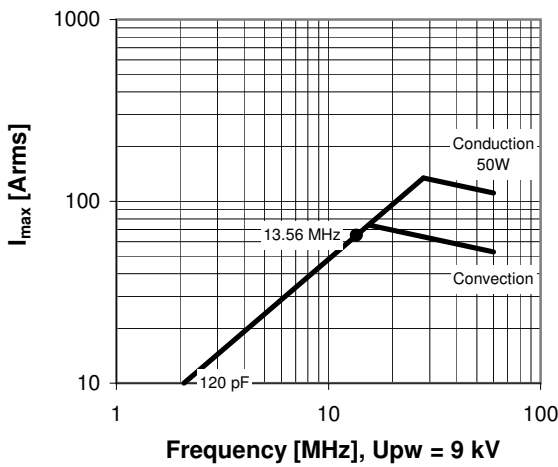

Special Features:
Capacity Tolerance 5%